

O2Vent® Optima



Replacing Connector Bands – Instructions

The connector bands (bands) are essential for keeping your O2Vent Optima device assembled and to maintain the lower jaw position.

The bands are available in nine lengths (13mm–21mm) and two strengths: 'soft' (light blue) and 'firm' (dark blue).

When should I replace the bands?

- It is recommended to change both bands monthly as they may lose elasticity.

How to identify that the bands need changing

- If the length of the current band is longer than a new band
- If the band's holes have stretched from circular to oval shape

Replacing connector bands on your O2Vent Optima

Step 1 – Separate the upper and lower device trays, as shown.

Step 2 – To remove, peel the band away from the wide end of the lug. Repeat on the second side.

Step 3 – Add the new band with the size/number facing out, by hooking the band opening over the narrow end of the lug and pulling it over the wide end.



To remove, peel the band away from the wide end of the lug.

Step 3 continued – Repeat this action with the other end of the band to connect the upper and lower trays.

Step 4 – Repeat step 3 with the second band.

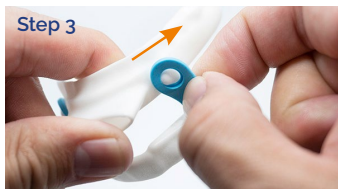

To add band, hook over narrow end of the lug and pull over the wide end.

RX ONLY

CONNECTOR BANDS CAN ONLY BE USED IN CONJUNCTION WITH **O2VENT OPTIMA** DEVICES



MANUFACTURER AND AUSTRALIAN SPONSOR:

Oventus Manufacturing Pty Ltd
1 Swann Road, Indooroopilly
QLD 4068 Australia
Toll Free in Australia:
(+61) 1300 533 159
customer@oventusmedical.com

MANUFACTURED FOR:

Oventus Medical USA, Inc.
Oventus Medical, Canada, Inc.
Toll free in USA:
1-866-835-0116
support@oventusmedical.com

O2Vent.com



Consult instructions for use.



US Federal Law restricts this device to sale by or on the order of a healthcare professional.



O2Vent[®]
Optima

R130.01_Mar 2020